

IR CAMERA

DIC-ZC10GIR

**30X AF ZOOM
TDN, 570TVL**

Features

- 1/4" Sony super HAD CCD sensor / Auto focus X30 Zoom
- Day & Night (IR Cut Filter removable), 500TV Line (Color), 570 TV Line (B/W)
- Digital noise reduction (SSNR)
- Digital low Shutter Speed (DSS): X2~X128
- Built in Gaint IR LED (10 EA) and CDS sensor
- RS485 Communication (ID255, Protocol selectable)

Picture



Dimensions

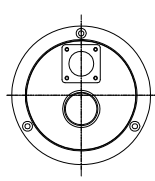
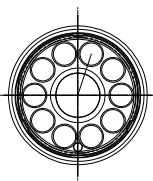
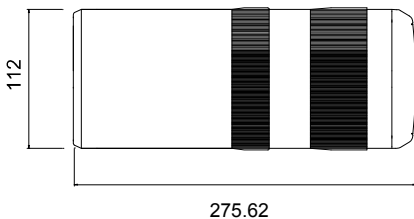
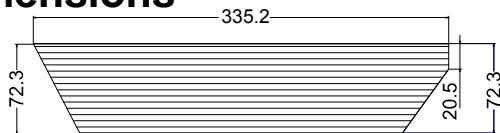

unit : mm

Specifications

MODEL	DIC-ZC10GIR
Image sensor	SONY 1/4" Super HAD CCD
Effective pixels	768(H)×494(V) NTSC 752(H)×582(V) PAL
Resolution	Color: 520 TVL / B/W: 570TVL
S/N ratio	More than 50dB (AGC OFF)
Iris control	Auto / Manual
Minimum illumination	0.7 Lux. @F1.8(Color) / 0Lux – IR LED ON(B/W)
White balance	ATW / AWC / MANUAL
Gain control	Normal / High / Off
Focus	Auto / Focus / One Shot
Communication	RS485(255 ID),
OSD	Full Function OSD Control
IR function	Approx. 100m ± 10m (Giant LED)
Lens	x30 Optical Zoom, f=3.3~99mm, F1.6(Wide)~F3.4(Tele)
SSNR	Off / Low / Middle / High
Privacy zones masking	4 Zones
Special function	Heater, Real Time Clock, IR on ILL. Selectable, Image Flip
Digital zoom	x2 ~ x10
ESC	Auto (x128, 1/60 ~ 1/120000)
BLC	Off / Low / Middle / High
Preset point	8 presets
Video output	Composite (1.0VP-P/75Ω)
Operating temperature	-20℃~50℃ (-4°F~ 104°F)
Power supply	DC 12V-30V, AC24V
Operating humidity	RH 85% MAX
Power consumption	DC12V : 3.2A ~ DC30V : 1.5A, AC12V : 2.3A ~ AC24V : 1.5A
Weight	About 3KG